

WM | AIA

NEWSLETTER



KUHN RIDDLE ARCHITECTS AND MORGAN STUDIO
FLORENCE RECREATION PAVILION
FLORENCE MASSACHUSETTS

WINTER 2017

2016 WMAIA ANNUAL DINNER GATEWAY CITY ARTS HOLYOKE MASSACHUSETTS



WMAIA's annual meeting and awards program was held on December 1, 2016. It was a festive event held at Gateway City Arts in Holyoke and sponsored by Pella. A tour of the building was provided by building owners Vitek Gruta and Lori Divine and architect Siegfried Porth AIA. If you missed the event – check out this facility when you have the chance! In addition to the Awards (see p. 3-7) we presented two student scholarships (p. 8). Honorary memberships were presented to State Rep. 3rd Hampshire District Ellen Story and to Holyoke Director of Planning & Economic Development Marcos A. Marrero. Finally we welcomed Christopher Novelli to the WMAIA board and said good-bye and thank you to Kayla Farrell and longtime member Julie Waggoner.



IN THIS ISSUE

ONE WMAIA DESIGN AWARDS & ANNUAL DINNER PHOTOS

TWO LETTER FROM WMAIA PRESIDENT

THREE THROUGH EIGHT DESIGN AWARDS + STUDENT SCHOLARSHIPS

NINE + TEN DESIGN RESEARCH IN INDIA CAREY CLOUSE AIA

ELEVEN + TWELVE THINGS TO DO + SEE

THIRTEEN + FOURTEEN FEATURED ARTISAN: LIZ CANALI LIGHTING WITH FELT

FIFTEEN WMAIA PROGRAMS

THE WESTERN MASSACHUSETTS CHAPTER OF THE AMERICAN INSTITUTE OF ARCHITECTS

THE WMAIA NEWSLETTER IS PUBLISHED FOUR TIMES A YEAR. IT IS CIRCULATED TO ALL MEMBERS, ADVERTISERS AND SUBSCRIBERS. PLEASE DIRECT ALL NEWSLETTER CORRESPONDENCE TO RACHAEL CHASE ASSOCIATE AIA, AT EDITOR@WMAIA.ORG. ARTICLES, PHOTOS, NOTICES OF EVENTS AND OTHER INFORMATION ARE WELCOME. OPINIONS EXPRESSED IN THE NEWSLETTER ARE NOT NECESSARILY THOSE OF THE WMAIA.

COVER PHOTO: JS PHOTO

LETTER FROM WMAIA PRESIDENT HELEN FANTINI AIA

Dear WMAIA Member,
Happy New Year!

In 2016 ...we upgraded our print newsletter to all color and welcomed over 80 people to our Annual Meeting/Awards program in December. Two SDATs (Sustainable Design Assessment Teams) provided significant funds from AIA National for towns in our region to address critical planning and design issues with the assistance of our member volunteers. A December exhibition at the APE Gallery in Northampton highlighted this work.

This year we look forward to several interesting building tours including the new Design Building at UMASS (Leers Weinzapfel), which is opening this month, and the Hitchcock Center for the Environment (designLAB architects). A design competition, in conjunction with the City of Northampton, will focus on affordable housing, our ever-popular film series will resume in the spring and important continuing education programs – particularly related to changes in the building code – are in the works. We are in the process of establishing two committees – Women in Architecture and COTE (Committee on the Environment) – you can expect to hear more about these in the coming months. And finally, we are planning a day of service in the new year.

I hope you will take advantage of these local program opportunities!

Email is our primary means of communication with you – please let Lorin (director@wmaia.org) if you are not receiving monthly email communications from the chapter.



WMAIA

EXECUTIVE COMMITTEE

PRESIDENT:

HELEN FANTINI AIA

PRESIDENT ELECT:

LUDMILLA PAVLOVA AIA

TREASURER:

DOUG MARSHALL AIA

SECRETARY:

JASON NEWMAN AIA

PAST PRESIDENT:

CHRIS FARLEY AIA

MEMBERS:

CAREY CLOUSE AIA

CHRISTOPHER NOVELLI AIA

GARRISON PIERS-GAMBLE AIAS

STEPHEN SCHREIBER FAIA

GARTH SCHWELLANBACH AIA

KRISTIAN WHITSETT AIA

EXECUTIVE DIRECTOR:

LORIN STARR

NEWSLETTER EDITOR:

RACHAEL CHASE ASSOCIATE AIA

EMERGING PROFESSIONALS

COORDINATOR

LINDSAY SCHNARR ASSOCIATE AIA

ARCHITECT LICENSING ADVISOR (IDP)

JASON NEWMAN AIA

WEBSITE MANAGER

JULIE WAGGONER AFFILIATE WMAIA

SOCIAL MEDIA

GARRISON PIERS-GAMBLE AIAS

FILM SERIES

ANDREW BAGGE ASSOCIATE AIA

DISASTER ASSISTANCE COORDINATOR

JOHN ROBINSON AIA

WMAIA DESIGN AWARDS 2016

The Design Awards Program was co-hosted this year by the WMAIA and the Boston Society of Landscape Architects – Western Massachusetts Section. The competition was open to any building type or landscape anywhere in the world completed at any time in the last ten years, by any architect or landscape architect whose principal office is currently located in Western Massachusetts (Berkshire, Franklin, Hampden and Hampshire counties), or if the project architect is a member of WMAIA. The foremost judging criterion is design excellence.

AIA Westchester Hudson Valley provided the jury, comprised of five design professionals:
Manuel Andrade AIA, Suffern NY;
Greg DeAngelis AIA, Mamaroneck NY; George Gaspar AIA, Mount Kisco NY; John A. Imbiario, White Plains NY, and Nicholas Viazzo Assoc. AIA, New Rochelle, NY.



HONOR AWARD: NASHAWANNUCK POND STREETSCAPE The Berkshire Design Group



JURY COMMENTS: Transformative to the key intersection in the industrial area of that town. The materials used were very fitting for the industrial mill character. The amphitheater was great! Like the different type of spaces that were created. The jury was encouraged that the local government was looking to benefit the community. Brought the people to the water and the water to the people.



ALL PHOTOS: BDG

WMAIA DESIGN AWARDS 2016

HONOR AWARD: FLORENCE RECREATION PAVILION MORGAN STUDIO KUHN RIDDLE ARCHITECTS



JURY COMMENTS: Graceful and elegant. For a simple function, the architect put a lot of thought into a connection to history, the circulation through the building, and the scale of the residential v. the recreation areas. It's hard to do something very simple... this hit the nail on the head. The jury liked that the two pavilions were treated differently (in terms of voids and solids). Presentation was great; it explained the project very well.



BOSTON SOCIETY OF LANDSCAPE ARCHITECTS
WESTERN MASSACHUSETTS SECTION



**AIA Western
Massachusetts**

ALL PHOTOS: JM PHOTO

WMAIA DESIGN AWARDS 2016

MERIT AWARD: RW KERN CENTER

THE BERKSHIRE DESIGN GROUP
BRUNER / COTT ARCHITECTS



MERIT AWARD: CARR RESIDENCE

STEPHEN GERALD
DIETEMANN ARCHITECT AIA



MERIT AWARD: PLAINS ELEMENTARY SCHOOL

JONES WHITSETT ARCHITECTS
CONSULTING ARCHITECTS: NAC ARCHITECTS



MERIT AWARD: GROVE STREET CONDOMINIUM

JONES WHITSETT ARCHITECTS



WMAIA DESIGN AWARDS 2016

CITATION AWARD: COLEGROVE PARK SCHOOL

JONES WHITSETT ARCHITECTS
ASSOCIATED ARCHITECT: DIETZ & COMPANY



CITATION AWARD: THE BAYSTATE CHILDREN'S HOSPITAL PLAYDECK

STEFFIAN BRADLEY ARCHITECTS



CITATION AWARD: OLYMPIA OAKS MULTIFAMILY AFFORDABLE HOUSING

KUHN RIDDLE ARCHITECTS



CITATION AWARD: HIGH TIDE AT RFK GREENWAY

CAROLINA ARAGON

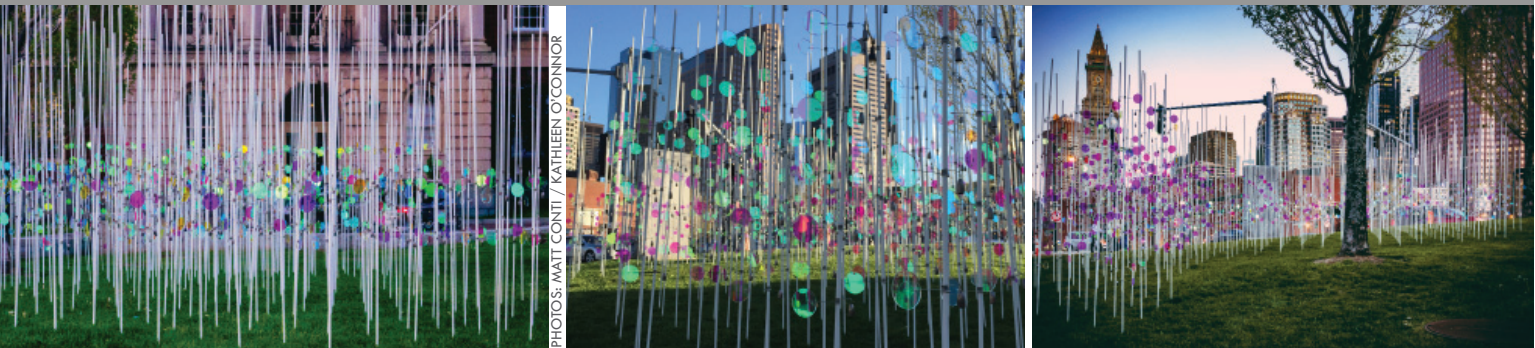

WMAIA DESIGN AWARDS 2016

CITATION AWARD: ARRIVALS: PUBLIC ART + INFRASTRUCTURE PROJECT



PHOTOS: CARYN BRAUSE / JOSEPH KRUPCZYNSKI



SITELAB ARCHITECTURE & DESIGN CENTER FOR DESIGN ENGAGEMENT

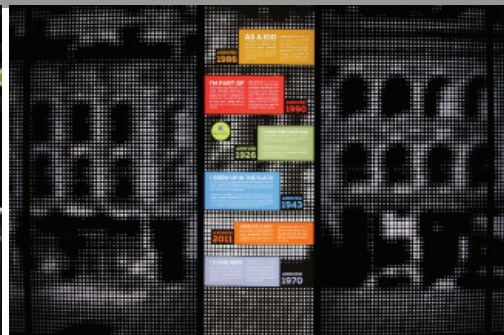

OTHER ENTRIES



BRUCE L. MARTIN PHOTOGRAPHY

BAYSTATE MODERN SURGERY MODERNIZATION
STEFFIAN BRADLEY ARCHITECTS

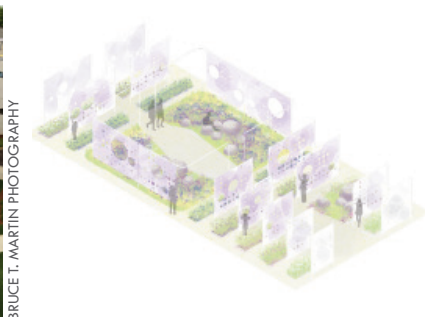

REVEALING VIOLET GARDEN FESTIVAL
PARI RIAHI ARCHITECTS, INC.



TRANS...GARDEN
PARI RIAHI ARCHITECTS, INC.



PHOTO: HANOVER PAVERS

KERNAN STUDIO
NAOMI DARLING ARCHITECTURE LLC



NITOBE MEMORIAL HALL (UNBUILT)
NAOMI DARLING ARCHITECTURE LLC



PHOTO: HANOVER PAVERS

STEVENS MEMORIAL SENIOR HOUSING
STUDIO ONE INC.

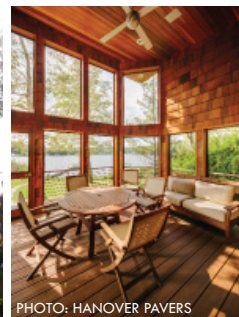

PHOTO: HANOVER PAVERS

MONTEREY RESIDENCE
STEPHEN GERALD DIETEMANN AIA



PHOTO: HANOVER PAVERS

NORTH ADAMS HERITAGE STATE PARK TRANSFORMATION IMPROVEMENTS
THE BERKSHIRE DESIGN GROUP



PHOTO: HANOVER PAVERS

ANDERSON RESIDENCE
STEPHEN GERALD DIETEMANN AIA

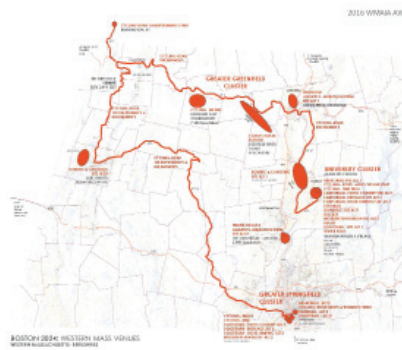

VISION 2024
THE BERKSHIRE DESIGN GROUP

WMAIA STUDENT SCHOLARSHIPS 2016

The 2016 WMAIA/AIA National Student Scholarships were presented to two UMASS M. Arch students. A \$1,000 scholarship was presented to Abhinav Bhargava and a \$500 scholarship to Erica Shannon.



ERICA SHANNON

The basis of this project is to create a live/work residential housing unit within a 20' x 20' building footprint. The structure is conceived for a land parcel bordering the Connecticut River in Hadley, MA.



The proposal in the Essex neighborhood of Lower Manhattan aims to revitalize the area through cutting edge design, environmental benefits and social links within the community. The program includes the Essex street market, Andy Warhol Art Museum, public spaces and residential apartments.



ABHINAV BHARGAVA

Eastern Architectural Representatives
Is the New England representative for **Firestone Building Products**.

What We Offer:

Solutions for a variety of building envelope systems including:

- Low-Slope Roofing Systems
- Steep-Slope Metal Roofing Systems
- Green Building Solutions
- Design & Estimating Services for Tapered Insulation and Metal Roofing Systems
- Top Quality Roof Hatch, Smoke Vents, Access Doors and Floor Hatches.

Eastern Architectural Representatives • (866) 533-1010 • eastern@easternar.com

JULLAY FROM LADAKH!

The trans-Himalayan mountains where I am working are considered arctic desert: this is a region characterized by scarce annual rainfall and long, punishing winters. And while the high-altitude landscape may appear to be too rugged and unforgiving for human settlement, Ladakh's tiny villages are comparatively lush, productive, and boundlessly hospitable.

I've spent the last month researching the problem of water scarcity in Ladakh---and the many creative coping strategies that subsistence agricultural farmers have devised for field irrigation in this context. Among them, ice stupas, snow barrier bands, water reservoirs, drip irrigation systems, and artificial glaciers stand out for their bootstrapping climate change defiance.

One such example can be seen at Warila Pass, where masonry snow barrier bands that have been built to tip snowdrift from one drainage into another. The long, linear masonry walls line the upper saddle of the mountain's south-facing watershed, where they block snow from moving into the northern drainage on the other side, since winter winds typically blow from the south.



Six different villages stand to benefit from this small-scale design intervention, as they host croplands well below the pass, all of which rely on glacial and snowfield meltwater for irrigation.

The Warila Pass snow barrier bands were built in 2013 using stones from the site and sweat equity from stakeholders. At an elevation just over 17,500', this was no easy task. According to program facilitators at the Leh Nutrition Project, several hundred volunteers from six different villages participated in the week-long build, many of whom experienced altitude sickness that required them to descend. The project is now complete, and it features at least nine different walls that range in size from forty feet to one hundred feet in length.

I've spent the last four summers documenting a number of these climate-adaptive design interventions in Ladakh, in an effort to better understand the low-tech, affordable solutions that can be used to combat climate-change challenges in high mountain communities. I'm curious about how people frame the problem of resource scarcity, how they mobilize their community networks to respond, and at the end of the day, how they intend to design their way out of it.



WRIGHT BUILDERS
Building Sustainably in
Western New England
since 1974.
Northampton, MA (413) 586.8287



Kuhn Riddle Architects
Only 3 Homes Left
Fulfilling a Designers' Mission through Leadership and Collaboration.
wright-builders.com



HAI Architecture
commercial | institutional
construction management
new homes | additions
design | renovations
info@wright-builders.com



Photo 1 (Opposite page): A moment of invincibility at the top of Warila Pass: yaks in the foreground, snow barrier bands behind.
Photo 2: Snow Barrier Bands at Warila Pass.
Photo 3: A typical Ladakhi village hosts lush green croplands in an otherwise harsh desert climate.

You want a collaborative M/E/P partner.



(413) 743-9500 • hec@hesnor.com • www.hesnor.com

We understand.

Since 1992, we've worked closely with the architectural community to ensure buildings perform the way they were envisioned.

We know your challenges and understand your needs.

We're proud to support AIA.

We're proud to support you.

HESNOR
ENGINEERING ASSOCIATES

CollectiveCopies in Amherst & Florence, MA

Committed to our community, the co-operative movement, and the arts since 1983



Express yourself!
Briefs, books & manuals
Programs & invitations
Color and b/w digital
Document scanning
Posters and cards

Plus Equal Exchange chocolate & other co-op-produced goods

Amherst 413.256.6425
Florence 413.586.5829

• On the Amherst Town Common
• Next to the Florence Diner

www.collectivecopies.com



ART Engineering
we build the future.

38 Front Street FL 3 Worcester, MA 01608
t. 508-797-0888 f. 508-797-5130

mica blue CREATIVE

Julie Waggoner
Affiliate WMAIA
jwaggoner@micablue.com
413-655-2200

Graphic Design
Web Design
Copy Writing
Photography



IT'S **olander** FOR **brick**

JONATHAN T. OLANDER

EDWIN L. OLANDER, INC. PHONE (413) 586-5608
P.O. BOX 236 FAX (413) 586-2376
NORTHAMPTON, MA 01061 CELL (413) 537-3601
OLANDERBRICK.COM j.olander@comcast.net

Rock Solid
Geotechnical Services

www.oto-env.com

O'Reilly, Talbot & Okun
[ASSOCIATES]

Quality, Safety, Experience.
Our people make us more than metal and glass.

Chandler Architectural Products, Inc.

255 Interstate Drive
West Springfield, MA 01089
Tel: (413) 733-1111 Fax: (413) 737-6101



Supporting
the
Architectural
Community

Dennis O'Rourke
dorourke@184.pellapdsn.com



Photo: Adam Lalpison
Kuhn Riddle Architects

VIEWED TO BE THE BEST.®

THINGS TO DO + SEE IN WESTERN MASSACHUSETTS

MASS MoCA

For In Harmonicity, the Tonal Walkway, Julianne Swartz started with a chart she found in a 19th-century music pedagogy system called the "Tonic Sol-Fa" School, developed by John Curwen. The chart assigned "mental effects" to the seven tones of the diatonic scale. Swartz was interested in this idea of certain tones activating specific emotional or mental states. She then took this "Curwen Method" and applied it to a new sound work for MASS MoCA, on long-term exhibition in the walkway between the lobby and the Sol LeWitt Wall Drawing Retrospective.

JULIANNE SWARTZ
IN HARMONICITY, THE TONAL WALKWAY



3 Mi	
2 Re	
1-Do	
7 Ti	The Piercing Tone
6 La	The Sad Tone
5 So	The Bright Tone
4 Fa	The Desolate Tone
3 Mi	The Calm Tone
2 Re	The Hopeful Tone
1-Do	The Strong Tone
7 Ti	
6 La	
5 So	



STEFFANI JEMISON
PLANT YOU NOW, DIG YOU LATER

In her largest solo exhibition to date, New York-based artist Steffani Jemison uses the complicated role of language and literacy in black history to explore narration, abstraction, citizenship, education, and the role of the archive. At MASS MoCA, Jemison presents a sound work and an excerpt from a novella, along with her formally stripped-down, conceptually layered, and alluringly enigmatic photographs and drawings. The works center on alternative language systems constructed by black Americans and examines their subversive potential. The exhibition opens on March 18, 2017, with a reception from 5:30 to 7pm.

Berkshiremuseum



LAB 102, a space dedicated to community engagement and programs that promote curiosity, innovation, and invention, opened November 8 at the Berkshire Museum. In LAB 102, children and families will discover an array of hands-on activities focused on creative play and incorporating experiences that reflect concepts drawn from both the arts and science. Some of the rotating and changing experiences planned for LAB 102 include a number of self-directed creative play opportunities using an assortment of building

toys and materials such as Tegu magnetic blocks, colorful connector straws, LEGO, and regular wooden blocks. An oversized 'exquisite corpse'-style iterative drawing project will be offered, inviting visitors to add to and embellish the artwork created by previous participants.

Science-based activities will be available, from learning about electricity using miniature LED lights to discovering robotics and even exploring forensics. Collaborative art-making projects utilizing found objects and recycled or materials will be part of the LAB 102 experience as well.

KENT HICKS
CONSTRUCTION CO.

Deep Energy Retrofits
Net Zero Homes
413-296-0123

INTERESTED IN ADVERTISING?
CONTACT
DIRECTOR@WMAIA.ORG!

INTEGRITY
ENVIRONMENTAL CONSTRUCTION, INC.

Renovation & New Construction
Call 413-548-7919
See us at HILL DESIGN CONSTRUCTION
1110 Fulton Hill Road, Dalton, MA
www.integritybuild.com



planning
land surveying
civil engineering
optical alignment
project management
electrical engineering
structural engineering
mechanical engineering

50 Depot Street • Dalton, MA 01226
(413) 684-0925 • Fax (413) 684-0267
e-mail hill@hillengineers.com

FEATURED ARTISAN

LIZ CANALI
ARTISAN LIGHTING

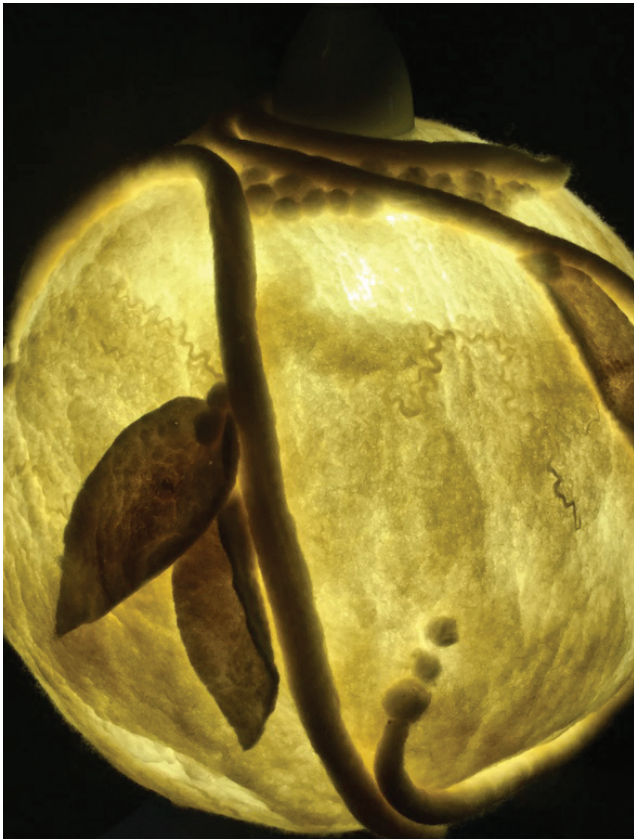

LIZ CANALI
HEATH MASSACHUSETTS

FEATURED ARTISAN

EXPLORATIONS IN FELT

Liz Canali's work focuses mainly on interior design with an emphasis on lighting, wall art and vessels. Liz takes traditional felting techniques and Japanese paper lantern design and applies it to illuminated felted pieces. The challenge is to make globes and shades look good when they are not lit and keep them "airy" enough to let the light show through while still strong enough to hold up without using frames. The light produced is a warm ambient light. A variety of one-of-a-kind designs, sizes and shapes make this a most unique product. Lamps are on display and for sale at the Salmon Falls Art Gallery in Shelburne Falls Massachusetts. Multiples in similar style and size are available by commission.

www.lizcanali.com

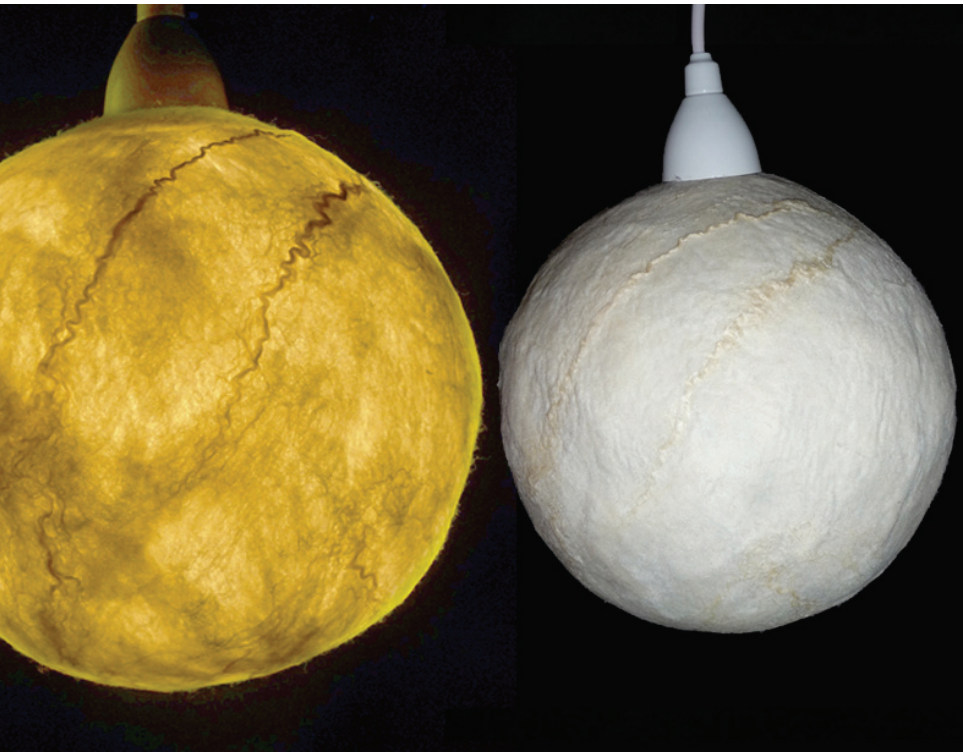
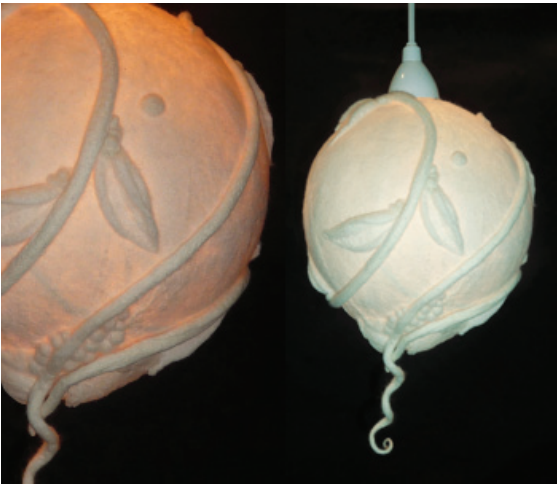

Congratulations 2016 MARVIN ARCHITECTS Challenge Winners



2016 WINNER - BEST COMMERCIAL
THE FEDERIC C. HAMILTON MATH AND SCIENCE CENTER, Millbrook, NY
Architect: Daniela Holt Voith
Architect Firm: Voith & Mactavish Architects LLP



Let us help you turn your blueprints into beautiful spaces. To explore solutions for your next project, contact your Western Massachusetts Marvin Representative: Stephen Hoyt at 413.923.8321 or shoyt@awhastings.com



WOULD YOU LIKE TO NOMINATE SOMEONE FOR FEATURED ARTISAN?
EMAIL_EDITOR@WMAIA.ORG

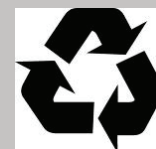

WM AIA programs

WMAIA SPRING 2017

TOUR & RECEPTION: NEW UMASS DESIGN BUILDING AT UMASS AMHERST

Friday, February 3, 4-6 PM

TOUR: HITCHCOCK CENTER FOR THE ENVIRONMENT (A LIVING BUILDING CHALLENGE PROJECT)

Wednesday, March 22

SPRING FILM SERIES: This spring we will screen the design trilogy: **Helvetica**, **Objectified** and **Urbanized**

Tuesday April 25: Helvetica

Tuesday May 2: Objectified

Tuesday May 9: Urbanized

Thanks to WMAIA's 2016-17 Sponsors and Corporate Affiliate Members!

COPPER SPONSORS



NICKEL SPONSORS



BRONZE SPONSORS



CORPORATE AFFILIATE MEMBERS, PROGRAM SPONSORS & ADVERTISERS:

c&h architects • Chandler Architectural Products • Collective Copies • Cows Building Supply • Dodson & Flinker Inc • Eastern Architectural Representatives
EDM Services Inc. • Engineering Design Associates • Hill Engineers, Architects & Planners • Kent Hicks Construction • Lexington Group Inc. • Menck Windows
MicaBlue Creative • MJ Moran • National Vinyl LLC • O'Reilly Talbot & Okun • Porter & Chester Institute

TINY HOUSE CONCEPT MODEL ON TOUR + COMING TO GREENFIELD

+ The first housing unit of its kind to be a 'living lab' where people can visit, hang out, and provide feedback.

+ Separate spaces for sleeping, bathing, storage, and entertaining - all in 385 SF. Furniture can be purchased on a budget and fits neatly in the rooms provided.

+ Built in a factory and shipped to site - a low cost, high quality method of construction. Units are built extra strong so that up to four units could be stacked on top of each other, and super insulated to save energy.

+ All systems, like heating, cooling, and water are built right in, so inhabitants have total control through integrated smart home technology.

+ Compact living is an advantageous living option for a wide range of age groups. In fact, senior communities already often include compact studios and one bedroom units, providing common cafeterias, lounges, and other areas that increase social interaction. For singles, young couples, or retirees, smaller living offers advantages to smaller households. With the flexibility that a uhu complex offers, you can imagine comfortable living, nearby amenities, and fantastic common play spaces for children.

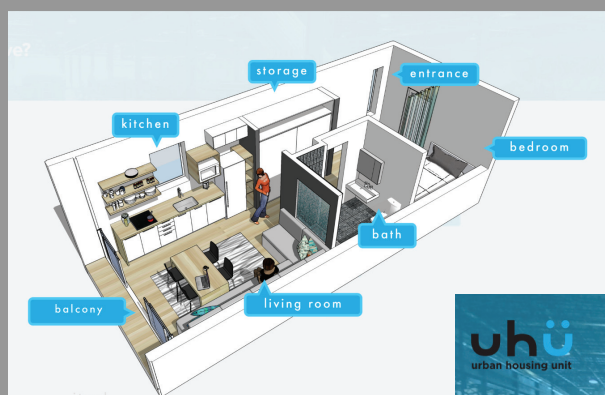

BSA SPACE

Greenfield Massachusetts intends to "host" the UHU at the site of their new Senior Center (corner of Pleasant, School & Davis Streets in Greenfield) which starts construction in 2017. For more info watch: www.greenfield-ma.gov.